

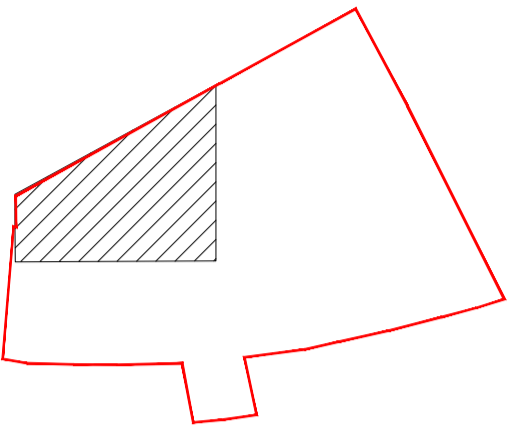

Notes:
DO NOT SCALE FROM THIS DRAWING. USE FIGURED DIMENSIONS IN ALL CASES. VERIFY DIMENSIONS ON SITE AND REPORT ANY DISCREPANCIES TO THE ARCHITECTS IMMEDIATELY. THIS DRAWING TO BE READ IN CONJUNCTION WITH THE ARCHITECTS SPECIFICATION. © THIS DRAWING IS COPYRIGHT AND MAY ONLY BE REPRODUCED WITH THE ARCHITECTS PERMISSION.

OS Licence Number: AR 032220
 Projection / Spatial Reference: Projected - RENET95 Irish Transverse_Mercator
 Centre Point Coordinates: X,Y = 71752.72982
 Reference Index: Map Series / Map Sheets
 1:1,000 | 3329.23
 1:1,000 | 3395.03
 Vertical Datum: Mean High
 Main Head

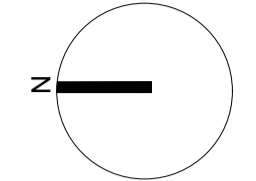

Key Plan

PLANNING LEGEND

SYMBOL	DESCRIPTION
	SITE BOUNDARY LINE
	TO BE DEMOLISHED

P2	28/08/20	LW	Planning
P1	25/02/20	LW	Pre-Planning ABP issue

Rev	Date	DRN	Description

Reddy Architecture + Urbanism
 Dairy Mills,
 Dairy Road,
 Dublin 6, D06 Y0E3
 T: +353 (0)1 4987000
 W: www.reddyarchitecture.com
 E: info@reddyarchitecture.com

Client Details:
 Orchid Residential Ltd,
 9 Clare Street, Dublin 2

Project Details:
 PROPOSED STUDENT RESIDENCE
 GOATSTOWN ROAD, DUBLIN 14

Drawing Title:
 Existing Site Plan - Ground Floor

Job No	Date	Scale@A1
19-181D	28.08.20	1:200
Status	Drawn By:	Checked By:
Planning	JB	LW
Purpose	Checked By:	Revision
Planning Permission	LW	

Drawing Number: 19-181D-RAU-ZZ-GF-DR-A-SVY-102
 Revision: P02

1 EXISTING SITE PLAN - GROUND FLOOR
 1 : 200